

These diagrams are based on the ones on the cover of the Origami Tanteidan (detectives) newsletter number 29 (December 15, 1994). I have not yet gotten it translated, so I am unable to give the author's name at this time.

The guesswork referred to can be found in the bases of several of John Montroll's designs including his *dromedary* and his *tyrannosaur*.

1) Montroll's guesswork method

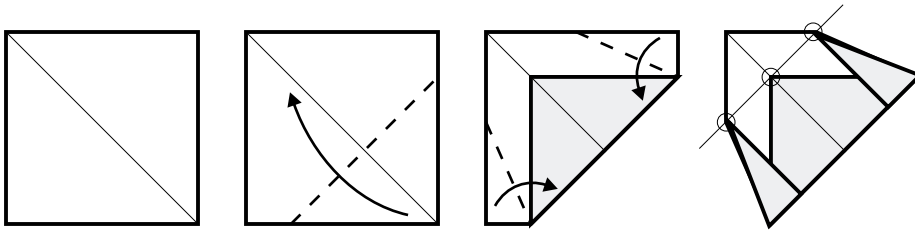

2) Formal method

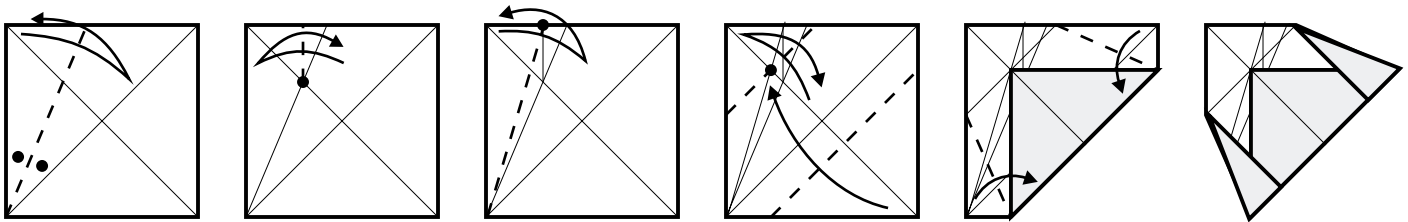

Another guesswork fold that sometimes appears is the following.

1) Montroll's guesswork method

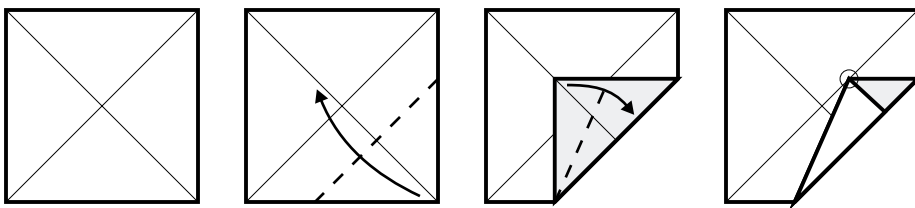

2) Formal method

